

IMPROVEMENT PRACTICES/ PERC STATUS	COLOR CODE
Soils have formed in acid shales and are moderately deep to bedrock. TDEC requires percolation tests to determine actual suitability for drainfield use. The unit is not suitable for this purpose without results of percolation tests. Armuchee soils are first percable.	Red
Soils with slopes between 30 and 50% require a Special Investigation of Soils (SIs) beyond the scope of this mapping. The unit is not rated for drainfield use at this time.	Not Coded
Area has been filled and will require an Extra-High Intensity Soils Map before any permit for fieldline installations may be made. An Extra-High Intensity Soils Map is beyond the scope of this investigation.	Red
Soil areas have been disturbed (cut, filled or compacted) and have not been tested for fieldline installations. A Special Investigation of Soils may reveal areas suitable for fieldline installations. A Special Investigation is beyond the scope of this mapping.	Red
Area has been badly gullied in the past and is not rated for drainfield use.	Red
Soils have formed in shale residuum and are augerable to depths of 36 inches or more within this delineation. The unit is considered non-karst percable and must have percolation tests to determine actual suitability for installation of conventional drainfield lines.	Red
Soils have formed in shale residuum and are typically augerable to depths of 36 inches or more. The unit delineated here has been badly eroded in the past and augerage occurs at depths that are generally less than 20 inches. Percolation tests are required and must be avoided for drainfield use.	Red

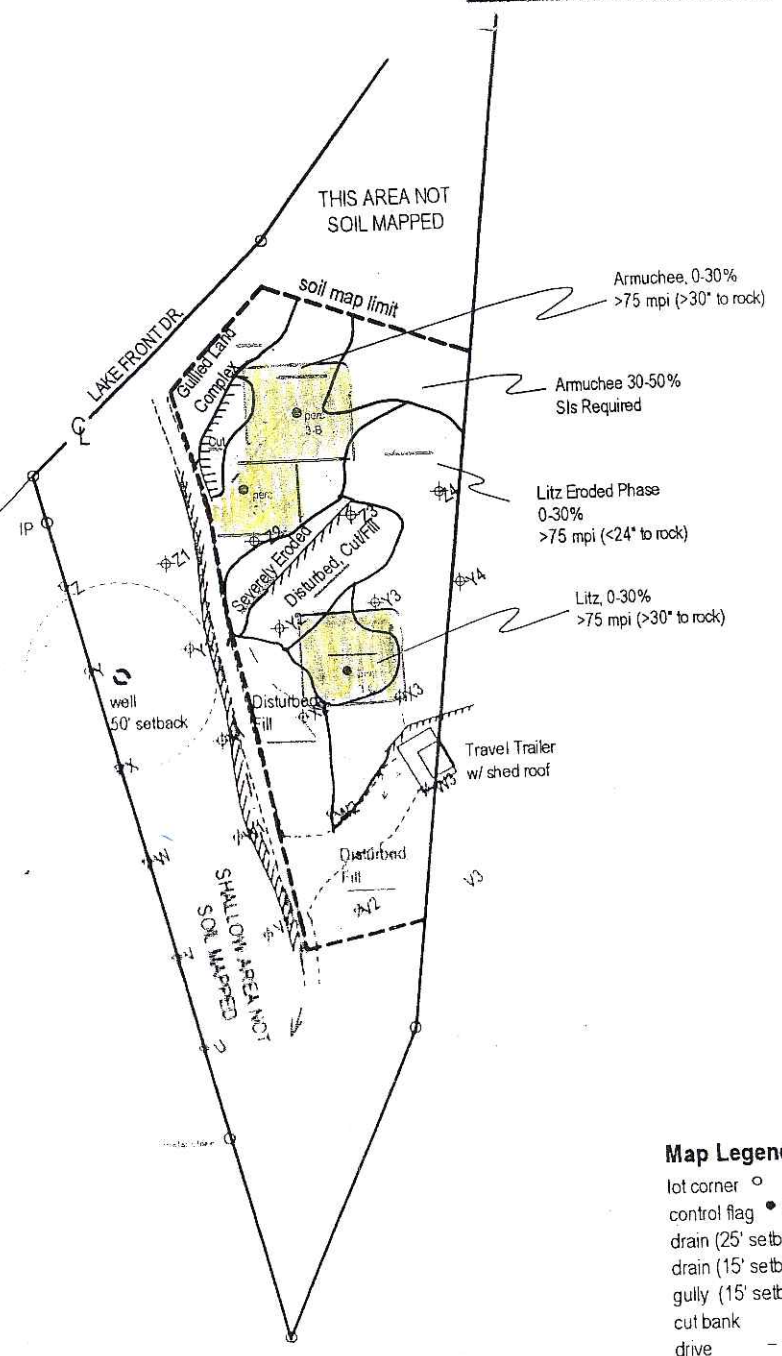

- Map Legend**
- lot corner ○
  - control flag ● A1
  - drain (25' setbacks) ————
  - drain (15' setbacks) - - - - -
  - gully (15' setbacks) ~~~~~
  - cut bank
  - drive
  - rock outcrop